

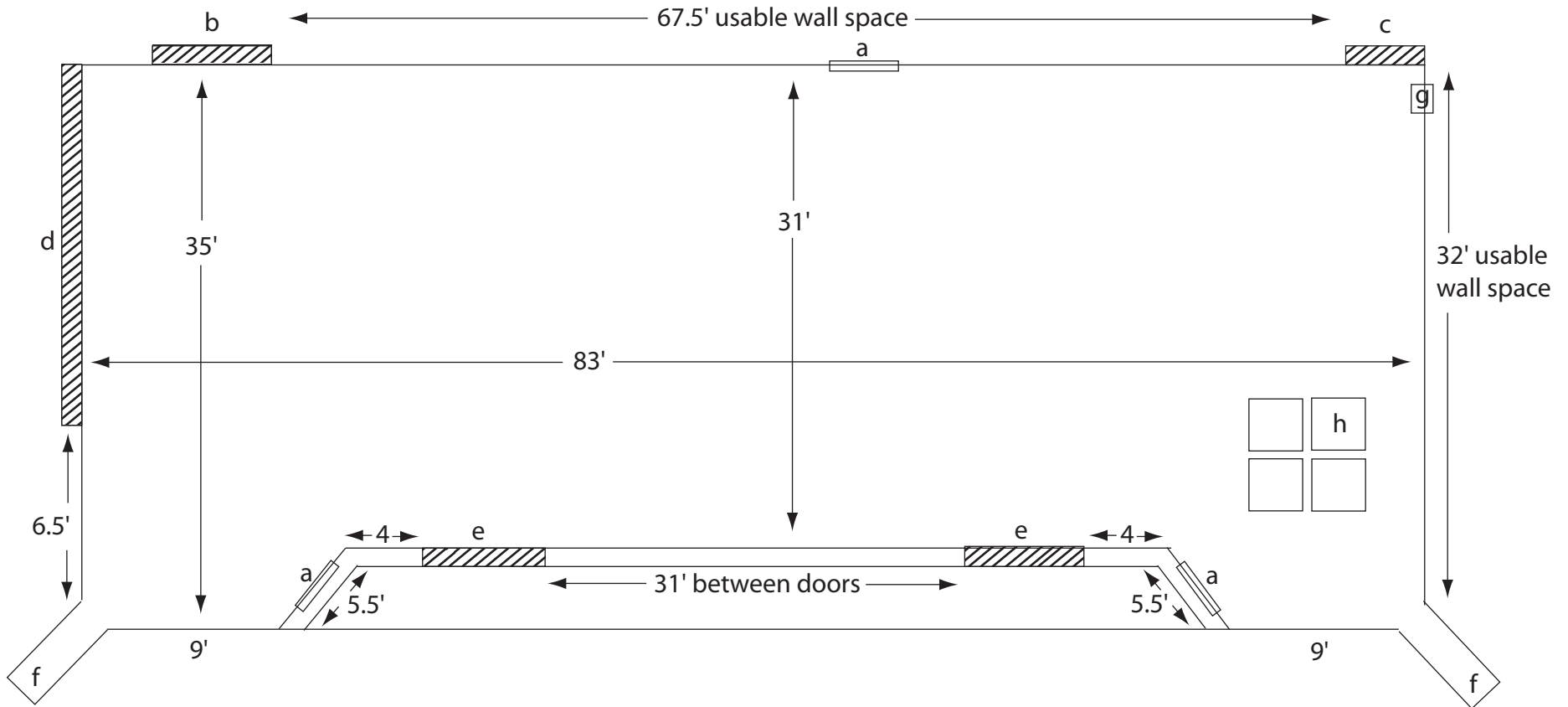

Floor Plan  
**Edwin W. Zoller Gallery**  
 Visual Arts Building, Penn State University Park Campus

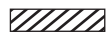

- a) building ventilation, near bottom of walls
- b) side double doors, secondary entrance with doors that open to hall
- c) emergency exit door to exterior of building
- d) main gallery entrance with large double slide-track glass doors, opens to cafe
- e) double doors with access to storage closets
- f) narrow vertical alcoves with gallery windows to cafe and outdoors
- g) fire extinguisher
- h) square frame hanging ceiling for movable walls, equipped with lighting tracks--hung in the center of ceiling 3 feet from walls leaving a perimeter around the gallery; moveable walls can only be configured at 90 degree angles

Ceiling height:  
 9.5' around wall perimeter  
 11' beneath ceiling grid

 doorways--cannot be blocked

 5 feet